

**MASTER PLAN LEGEND**

- EXISTING OUTDOOR PLAY / SPORTS
- EXISTING BUILDING OWNED BY SCHOOL
- ROADWAY - SEALED
- ROADWAY - UNSEALED
- EXISTING PATH
- EXISTING COVERED PATH
- EXISTING COURTS & COVERED PLAY
- BUILDING - PROPOSED
- COVERED PATH - PROPOSED
- ROADWAY - PROPOSED
- PATHWAY - PROPOSED
- DEMOLITION

**SITE DATA**

EXISTING GFA	4451m <sup>2</sup>
TOTAL PROPOSED GFA	7060m <sup>2</sup>
EXISTING IMPERVIOUS AREA	11699m <sup>2</sup>
TOTAL PROPOSED IMPERVIOUS AREA	15032m <sup>2</sup>
SITE AREA	40316m <sup>2</sup>
LEASED AREA	5280m <sup>2</sup>

REV	DATE	DETAILS	DRAWN BY
11	09.07.24	UPDATED MID SET	MD
10	04.07.24	UPDATED MID SET	MD
9	19.03.24	REVISED ELC WORK	DM
8	28.02.24	REVISED ELC WORKS	SC
7	21.02.24	BOARD APPROVAL	SC
6	16.01.24	BOARD APPROVAL	MD
5	12.01.24	FOR REVIEW	MD
4	14.12.23	UPDATED MP	RP
3	21.09.23	AREAS UPDATE	SC

**novum**

Client  
TRINITY ANGLICAN SCHOOL - KEWARRA

Project  
TAS - KEWARRA BEACH MASTERPLAN

Drawing Title  
SITE PLAN - EXISTING

Drawing Reference  
**0236-MID-001-11**

Status  
PRELIMINARY

Scale at A1 1:500  
1:500 0 5 10 15 20 25m

07 3853 8383 novum.com.au

© COPYRIGHT This drawing and design is property of Novum Pty Ltd. Using, retaining or copying this drawing or design without written permission from Novum Pty Ltd is strictly prohibited. Use figured dimensions in preference to scale. Verify all figured dimensions on site.

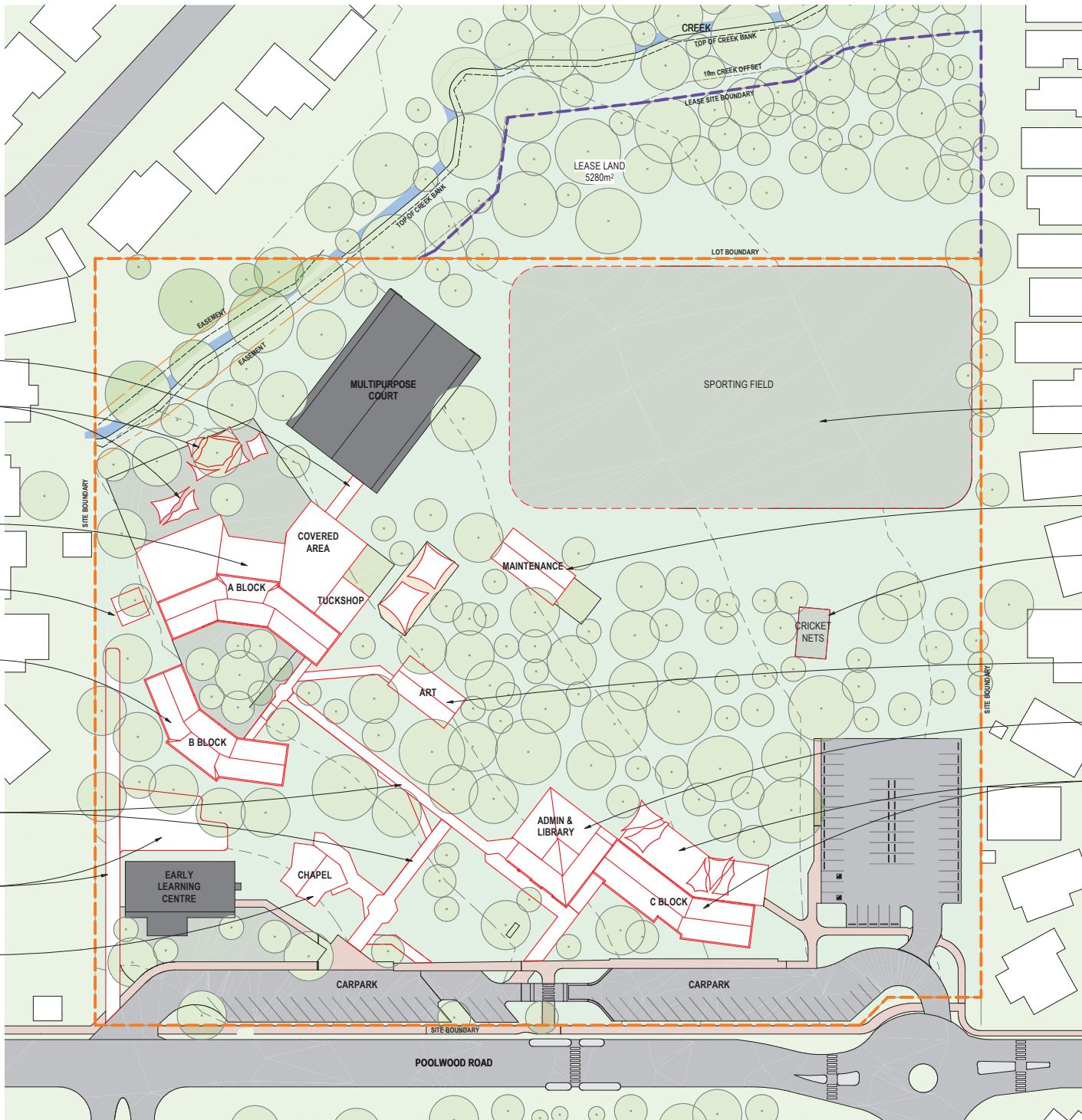

**MASTER PLAN LEGEND**

- EXISTING OUTDOOR PLAY / SPORTS
- EXISTING BUILDING OWNED BY SCHOOL
- ROADWAY - SEALED
- ROADWAY - UNSEALED
- EXISTING PATH
- EXISTING COVERED PATH
- EXISTING COURTS & COVERED PLAY
- BUILDING - PROPOSED
- COVERED PATH - PROPOSED
- ROADWAY - PROPOSED
- PATHWAY - PROPOSED
- DEMOLITION

**SITE DATA**

EXISTING GFA	4451m <sup>2</sup>
TOTAL PROPOSED GFA	7060m <sup>2</sup>
EXISTING IMPERVIOUS AREA	11699m <sup>2</sup>
TOTAL PROPOSED IMPERVIOUS AREA	15032m <sup>2</sup>
SITE AREA	40316m <sup>2</sup>
LEASED AREA	5280m <sup>2</sup>

- DEMOLISH COVERED PATH
- REMOVE SUN SAILS
- DEMOLISH A BLOCK, COVERED AREA & TUCKSHOP
- DEMOLISH SHED
- DEMOLISH B BLOCK
- DEMOLISH COVERED PATHWAYS
- DECOMMISSION ACCESS TRACK & INFORMAL PARKING AREA
- DEMOLISH CHAPEL

- DECOMMISSION SPORTING FIELD
- DEMOLISH MAINTENANCE SHED
- DEMOLISH CRICKET NETS
- DEMOLISH ART BUILDING & PATH
- DEMOLISH ADMIN AND LIBRARY
- DEMOLISH C BLOCK, SUN SAILS AND OUTDOOR AREA

REV	DATE	DETAILS	DRAWN BY
10	09.07.24	UPDATED MID SET	MD
9	04.07.24	UPDATED MID SET	MD
8	19.03.24	REVISED ELC WORKS	DM
7	28.02.24	REVISED ELC WORKS	SC
6	21.02.24	BOARD APPROVAL	SC
5	16.01.24	BOARD APPROVAL	MD
4	14.12.23	UPDATED MP	RP
3	21.09.23	AREAS UPDATE	SC
2	04.09.23	AREAS UPDATE	SC

**novum**

Client  
TRINITY ANGLICAN SCHOOL - KEWARRA

Project  
TAS - KEWARRA BEACH MASTERPLAN

Drawing Title  
SITE PLAN - DEMOLITION

Drawing Reference  
**0236-MID-012-10**

Status  
PRELIMINARY

Scale at A1 1:500  
1:500 0 5 10 15 20 25m

07 3853 8383 novum.com.au

© COPYRIGHT This drawing and design is property of Novum Pty Ltd. Using, retaining or copying this drawing or design without written permission from Novum Pty Ltd is strictly prohibited. Use figured dimensions in preference to scale. Verify all figured dimensions on site.

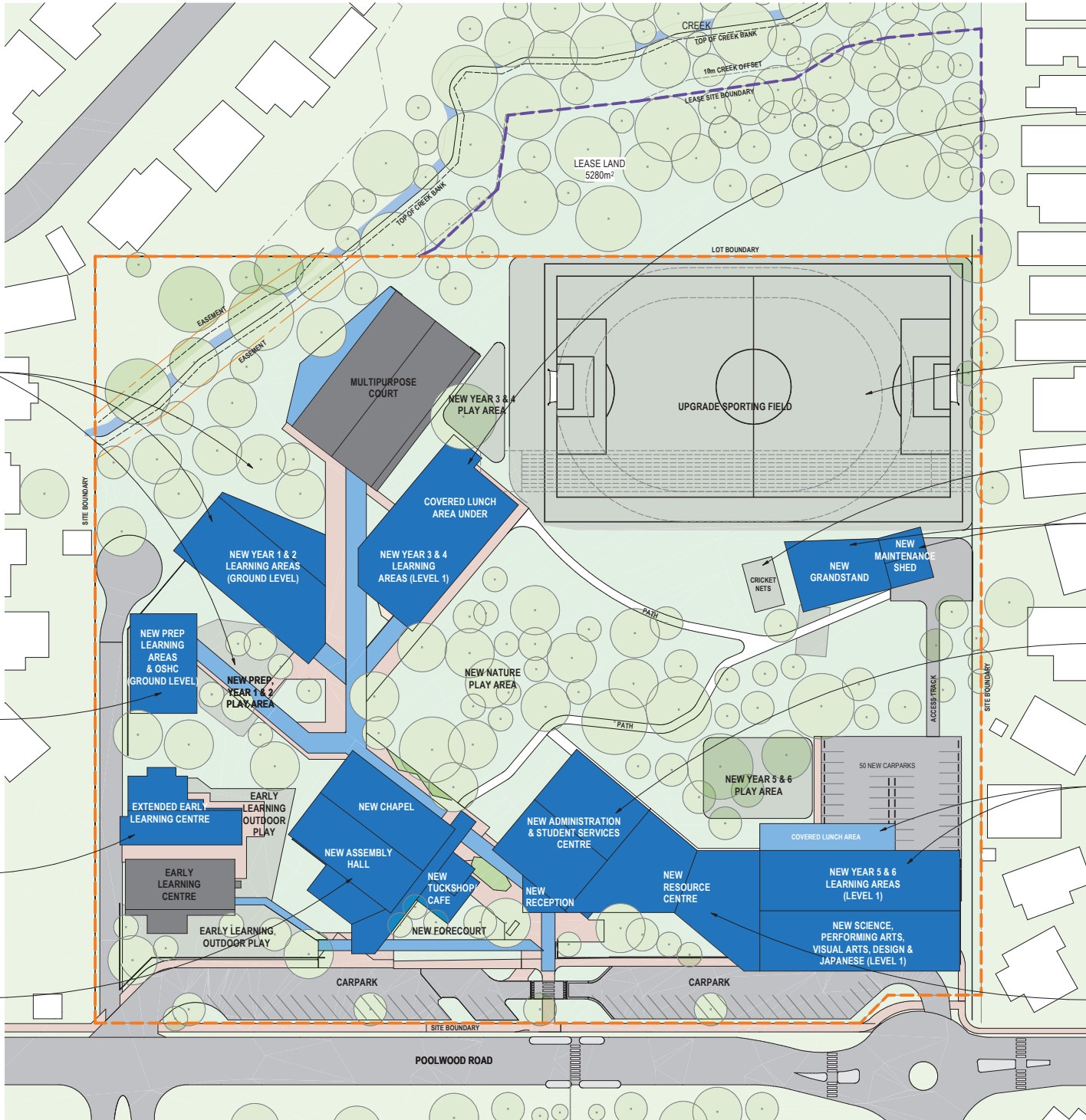

**MASTER PLAN LEGEND**

- EXISTING OUTDOOR PLAY / SPORTS
- EXISTING BUILDING OWNED BY SCHOOL
- ROADWAY - SEALED
- ROADWAY - UNSEALED
- EXISTING PATH
- EXISTING COVERED PATH
- EXISTING COURTS & COVERED PLAY
- BUILDING - PROPOSED
- COVERED PATH - PROPOSED
- ROADWAY - PROPOSED
- PATHWAY - PROPOSED
- DEMOLITION

**SITE DATA**

EXISTING GFA	4451m <sup>2</sup>
TOTAL PROPOSED GFA	7060m <sup>2</sup>
EXISTING IMPERVIOUS AREA	11699m <sup>2</sup>
TOTAL PROPOSED IMPERVIOUS AREA	15032m <sup>2</sup>
SITE AREA	40316m <sup>2</sup>
LEASED AREA	5280m <sup>2</sup>

**NEW ADMINISTRATION & STUDENT SERVICES CENTRE**

- Main Reception & Administration
- Teachers and Staff Hub (learning, collaboration gathering and recreation)
- Meeting Rooms
- Wellbeing & Health Hub
- Extension & Enrichment Hub
- Pastoral Care Hub
- Amenities

REV	DATE	DETAILS	DRAWN BY
11	16.07.24	UPDATED MID SET	MD
10	09.07.24	UPDATED MID SET	MD
9	04.07.24	UPDATED MID SET	MD
8	19.03.24	REVISED ELC WORK	DM
7	28.02.24	REVISED ELC WORKS	SC
6	21.02.24	BOARD APPROVAL	SC
5	16.01.24	BOARD APPROVAL	MD
4	14.12.23	UPDATED MP	RP
3	21.09.23	AREAS UPDATE	SC

**NOVUM**

**PROJECT**  
0236 TAS - KEWARRA BEACH  
MASTER PLAN

**CLIENT**  
TRINITY ANGLICAN SCHOOL - KEWARRA

**SITE LOCATION**  
POOLWOOD ROAD, KEWARRA BEACH QLD 4879

**DRAWING TITLE**  
SITE PLAN - PROPOSED

**DRAWING REFERENCE**  
MID-013

**REVISION**  
11

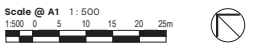

© COPYRIGHT This drawing and design is property of Novum Pty Ltd. Using, retaining or copying this drawing or design without written permission from Novum Pty Ltd is strictly prohibited. Use figured dimensions in preference to scale. Verify all figured dimensions on site.

**NEW YEAR 1 & 2 LEARNING AREAS**

- 4 x General Learning Areas (2 Stream Years 1-2) at Ground Level
- 2 x Breakout / Withdrawal Rooms
- New/Upgraded Years 1-2 Play Area
- Amenities
- Central covered area

**NEW PREP LEARNING AREAS AND NEW OSHC**

- 2 x Prep Learning Areas (2 Stream Prep) Ground Level
- Internal Circulation
- New/Upgraded Prep Play Area
- Amenities
- Staff Room / Offices Upper Level
- New OSHC

**EXPANSION OF EXISTING EARLY LEARNING CENTRE**

**NEW ASSEMBLY HALL & CHAPEL AND TUCKSHOP CAFE**

- 500 Seat Auditorium
- Lobby with Kitchentette
- Tuckshop / Cafe
- Amenities
- Backstage / Vestry
- Office

**NEW YEAR 5 & 6 LEARNING AREAS**

- 4 x General Learning Areas (2 Stream years 3-4)
- 2 x Breakout / Withdrawal Rooms
- Learning Commons / Internal Circulation
- Amenities
- Covered Lunch Area Under

**UPGRADED SPORTS FIELD WITH RUNNING TRACK**

**NEW CRICKET NETS**

**NEW GRANDSTAND AND MAINTENANCE COMPOUND**

**NEW YEAR 5 & 6 LEARNING AREAS**

- 4 x General Learning Areas (2 Stream years 5-6)
- 2 x Breakout / Withdrawal Rooms
- Learning Commons / Internal Circulation
- 2 x Science Lab
- 2 x Specialist Learning Areas
- Amenities
- Staff Room & Office
- Carpark at Ground Level

**NEW RESOURCE CENTRE**

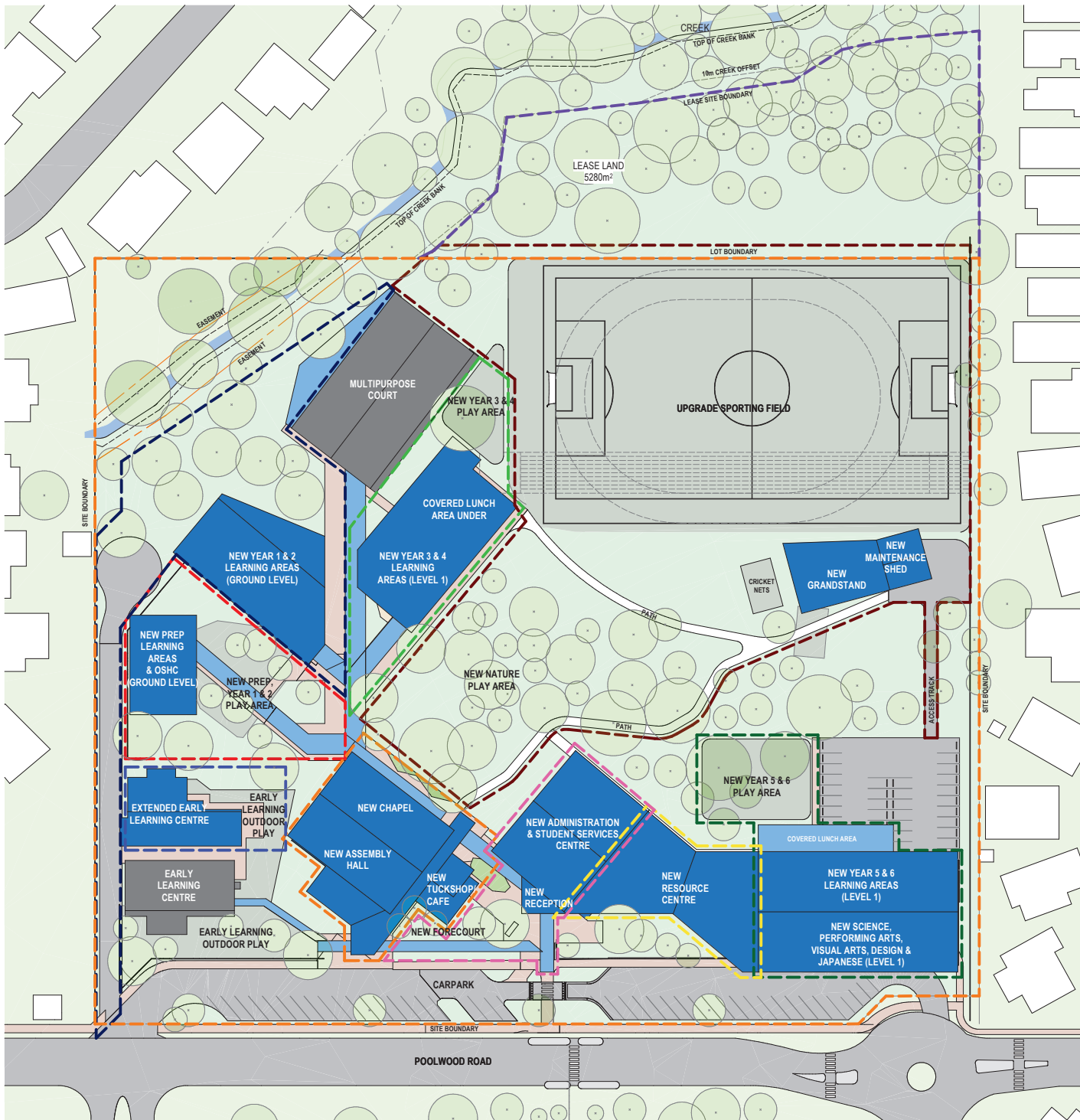

**PROPOSED STAGING**

- PRECINCT 1a** - [Blue dashed line]
- EXPANSION OF EXISTING EARLY LEARNING CENTRE
- PRECINCT 1d** - [Orange dashed line]
- NEW 500 SEAT AUDITORIUM AND TUCKSHOP CAFE
- PRECINCT 2a** - [Green dashed line]
- NEW YEAR 5 & 6 LEARNING AREAS AND SPECIALIST LEARNING AREAS
- PRECINCT 2b** - [Light green dashed line]
- NEW YEAR 3 & 4 LEARNING AREAS
- PRECINCT 3** - [Red dashed line]
- NEW PREP LEARNING AREAS
- EXPANDED ELC PLAY AREA
- NEW OSHC
- PRECINCT 4** - [Dark blue dashed line]
- NEW YEAR 1 & 2 LEARNING AREAS
- PRECINCT 5** - [Yellow dashed line]
- NEW RESOURCE CENTRE
- PRECINCT 6** - [Pink dashed line]
- NEW ADMINISTRATION & STUDENT SERVICES CENTRE
- PRECINCT 7** - [Dark red dashed line]
- UPGRADE SPORTING FIELD
- NEW GRANDSTAND
- NEW MAINTENANCE COMPOUND
- NEW NATURE PLAY AREA

**MASTER PLAN LEGEND**

- [Light grey box] EXISTING OUTDOOR PLAY / SPORTS
- [Dark grey box] EXISTING BUILDING OWNED BY SCHOOL
- [Medium grey box] ROADWAY - SEALED
- [Light brown box] ROADWAY - UNSEALED
- [Light pink box] EXISTING PATH
- [Dark pink box] EXISTING COVERED PATH
- [Light tan box] EXISTING COURTS & COVERED PLAY
- [Blue box] BUILDING - PROPOSED
- [Light blue box] COVERED PATH - PROPOSED
- [Dark blue box] ROADWAY - PROPOSED
- [White box with black border] PATHWAY - PROPOSED
- [Red box with black border] DEMOLITION

**SITE DATA**

EXISTING GFA	4451m <sup>2</sup>
TOTAL PROPOSED GFA	7060m <sup>2</sup>
EXISTING IMPERVIOUS AREA	11699m <sup>2</sup>
TOTAL PROPOSED IMPERVIOUS AREA	15032m <sup>2</sup>
SITE AREA	40316m <sup>2</sup>
LEASED AREA	5280m <sup>2</sup>

REV	DATE	DETAILS	DRAWN BY
13	16.07.24	UPDATED MID SET	MD
12	09.07.24	UPDATED MID SET	MD
11	04.07.24	UPDATED MID SET	MD
10	19.03.24	REVISED ELC WORK	DM
9	28.02.24	REVISED ELC WORKS	SC
8	21.02.24	BOARD APPROVAL	SC
7	16.01.24	BOARD APPROVAL	MD
6	12.01.24	FOR REVIEW	MD
5	14.12.23	UPDATED MP	RP

**NOVUM**

**PROJECT**  
0236 TAS - KEWARRA BEACH  
MASTERPLAN

**CLIENT**  
TRINITY ANGLICAN SCHOOL - KEWARRA

**SITE LOCATION**  
POOLWOOD ROAD, KEWARRA BEACH QLD 4879

**DRAWING TITLE**  
SITE PLAN - STAGING

**DRAWING REFERENCE**  
MID-014

**REVISION**  
13

